

Lower Road, Erlestoke, Devizes, Wiltshire, SN10 5UE

Tel: 01380 830 697

Email: info@coprisystems.com

For Industry



Contents

THE COPRISYSTEMS CONCEPT	2
REARWALL-MOUNTED CANOPIES	3
FREESTANDING CANOPIES	5
SIDEWALL-MOUNTED CANOPIES	7
DOMES	9
DOCK SHELTERS - GENERAL	11
TECHNICAL SPECIFICATIONS Canopies and Domes	13



THE COPRISYSTEMS CONCEPT

Leaders in the field of prefabricated, relocatable, lightweight buildings, CopriSystems has been designing, supplying and installing structures tailored to clients' needs for over twenty years.



CopriSystems' products are a simple short or long term solution providing all-weather protection against the elements for loading bays, storage or working space.

They conform to BS 6399 Building Regulations (snow and wind loadings)



and need minimum footings - an existing concrete slab will usually suffice.

CopriSystems' experience in problem-solving can help improve logistics and working conditions, reduce damaged goods, ultimately saving time and money.

Structurally engineered to exacting standards, CopriSystems supplies superior products which can be adapted to most customers' existing buildings to ensure high levels of performance and guarantee customer satisfaction.

TUNNEL CANOPY SYSTEM SPANS

All canopies are available in 2 standard heights of 4.3m & 5.0m, length as required. Non standard widths and heights available on request.

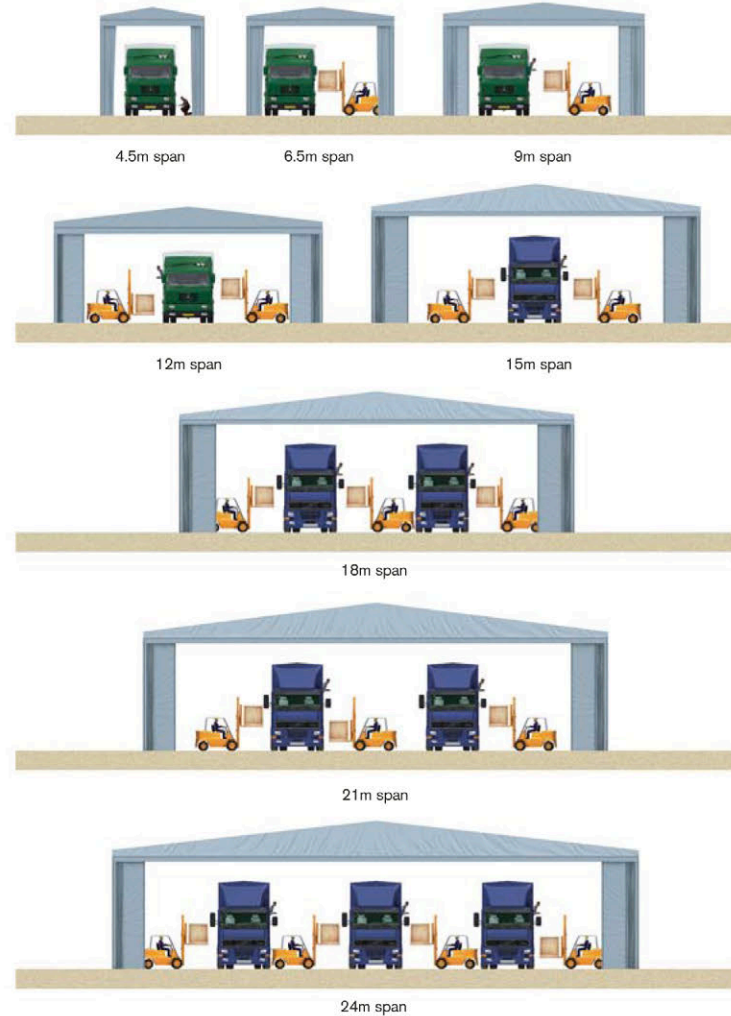

REARWALL-MOUNTED CANOPIES

Providing absolute protection against the elements - and peace of mind - CopriSystems' rearwall-mounted canopies are ideal for loading bay applications and marshalling of goods.

These front-opening canopies are fixed to an existing building and flashed as necessary. Alternative doors systems, including roller shutter or swing doors, dock shelters or reinforced sliding front curtains, can be fitted as required.

All canopies are available in various standard widths, 2 standard heights of 4.3m & 5.0m, lengths as required; see Specifications on page 13 for full details.

Key to images shown

- | | |
|---|-------------------------|
| 1 Width 6.5m x height 4.3m (retracted position shown ghosted) | 3 Width 12m x height 5m |
| 2 Width 9m x height 5m | 4 Width 18m x height 5m |
| | 5 Width 24m x height 5m |

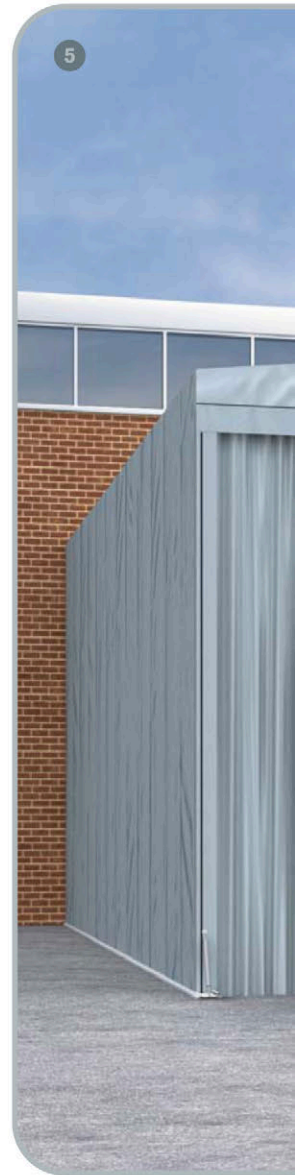



FREESTANDING CANOPIES

Freestanding canopies provide an ideal solution for flexible weather protection.

Fully relocatable, temporary or permanent, they are suitable for a range of applications, such as boat yards, vehicle washing and servicing, shot-blasting, or as a transhipment or storage facility. Door openings can be incorporated as required.

All canopies are available in various standard widths, 2 standard heights of 4.3m & 5.0m, lengths as required; see Specifications on page 13 for full details.

Key to images

- | | | | |
|---|-------------------------|----|--|
| 1 | Width 9m x height 4.3m | 4a | Width 18m x height 5m, shown retracted to allow hoist to position boat |
| 2 | Width 12m x height 4.3m | | |
| 3 | Width 18m x height 5m | | |
| 4 | Width 18m x height 5m | 5 | Width 24m x height 5m, shown open at rear |





SIDEWALL-MOUNTED CANOPIES

Perfectly suited for 'drive through' situations, these canopies provide environmental protection and avoid congestion.

Attached along one side of an existing building on load-bearing posts which support a high level beam, the CopriSystems sidewall-mounted canopy produces a tunnel effect with openings at both ends. Ends can be left open or closed to create an effective airlock when warehouse doors are opened. Sidewall-mounted canopies are available as a conventional double-pitched roof - with a gutter against the adjacent building - or in monopitch format, avoiding the need for a gutter.

Sidewall-mounted canopies are particularly suitable for manoeuvring of vehicles where space is restricted.

All canopies are available in various standard widths, 2 standard heights of 4.3m & 5.0m, lengths as required; see Specifications on page 13 for full details.

Key to images

- 1 Width 6.5m x height 4.3 with monopitch roof
- 2 Width 12m x height 5m
- 3 Width 24m x height 5m, rear door open showing drive through
- 4 Width 18m x height 5m with monopitch roof





DOMES

Stylish, strong and economical, with spacious interior, the CopriSystems domes readily lend themselves to large scale operations.

Available as a fixed or telescopic model depending on requirements. Fixed models provide weather protection for a wide range of applications. Internal height in the middle varies between 9m and 10m and, despite the curved shape, little internal height is lost at the sides, 5m being achieved approximately 1.5m from the edge. Telescopic models are ideal when frequent crane access is required for placing and removing large pieces of machinery.

Domes are available in any length and standard spans as shown below. Intermediate spans can be produced.

Key to images

- 1 Internal view of 25m dome with 10m x 5m canopy door
- 2 External view of dome with 10m x 5m canopy door at front and full height recoiling dock shelter (ST) to rear
- 3 Telescopic dome shown in closed position
- 4 Telescopic dome fully extended to allow container loading

Comparative spans/heights - internal

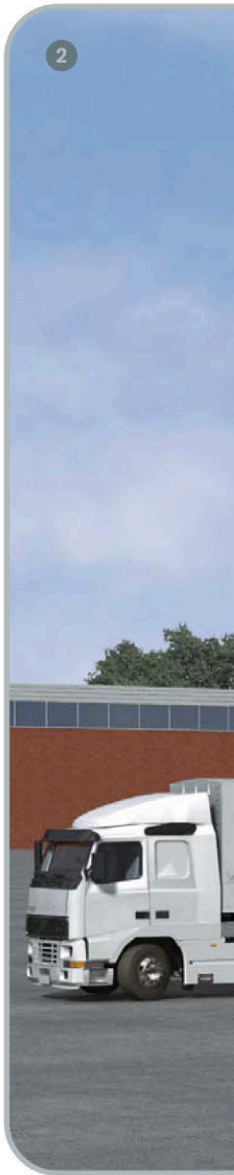
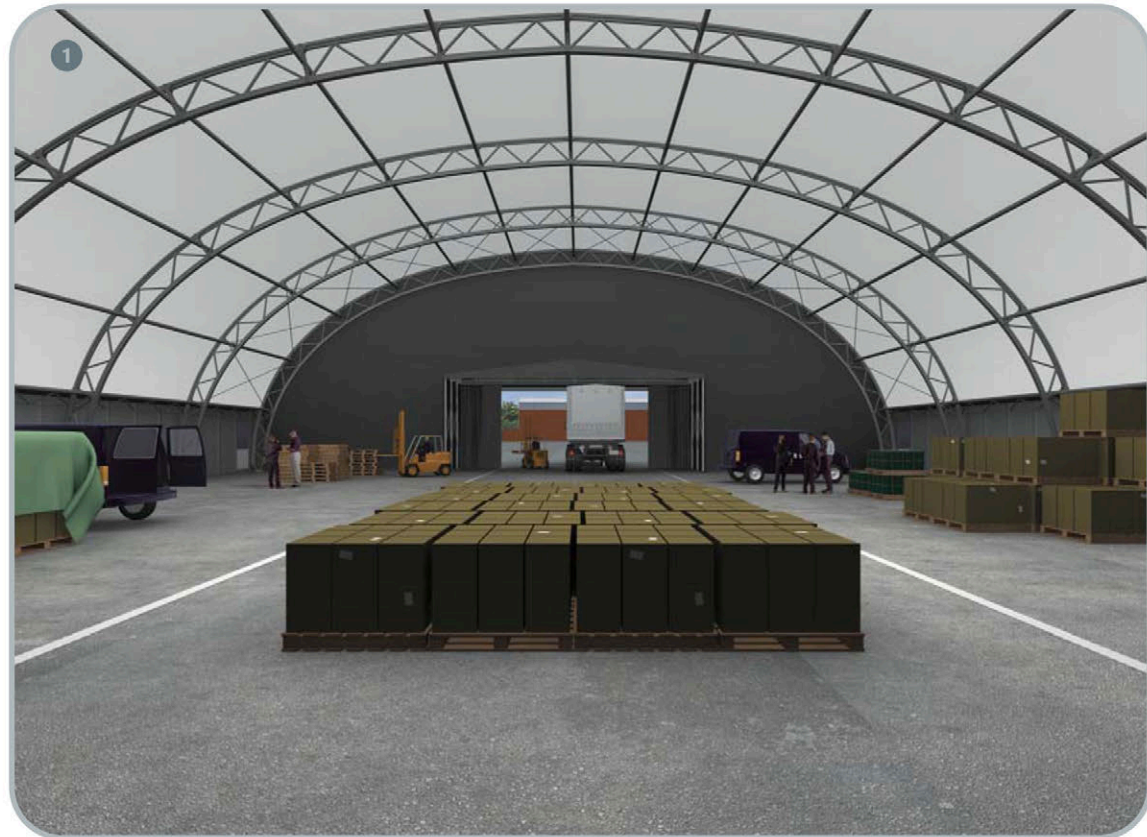
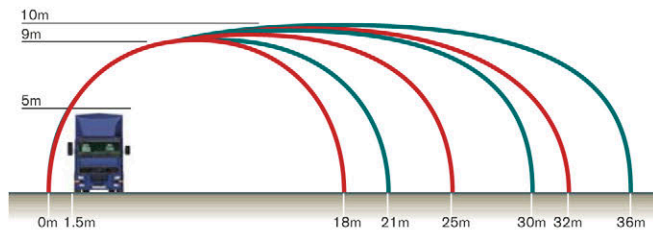

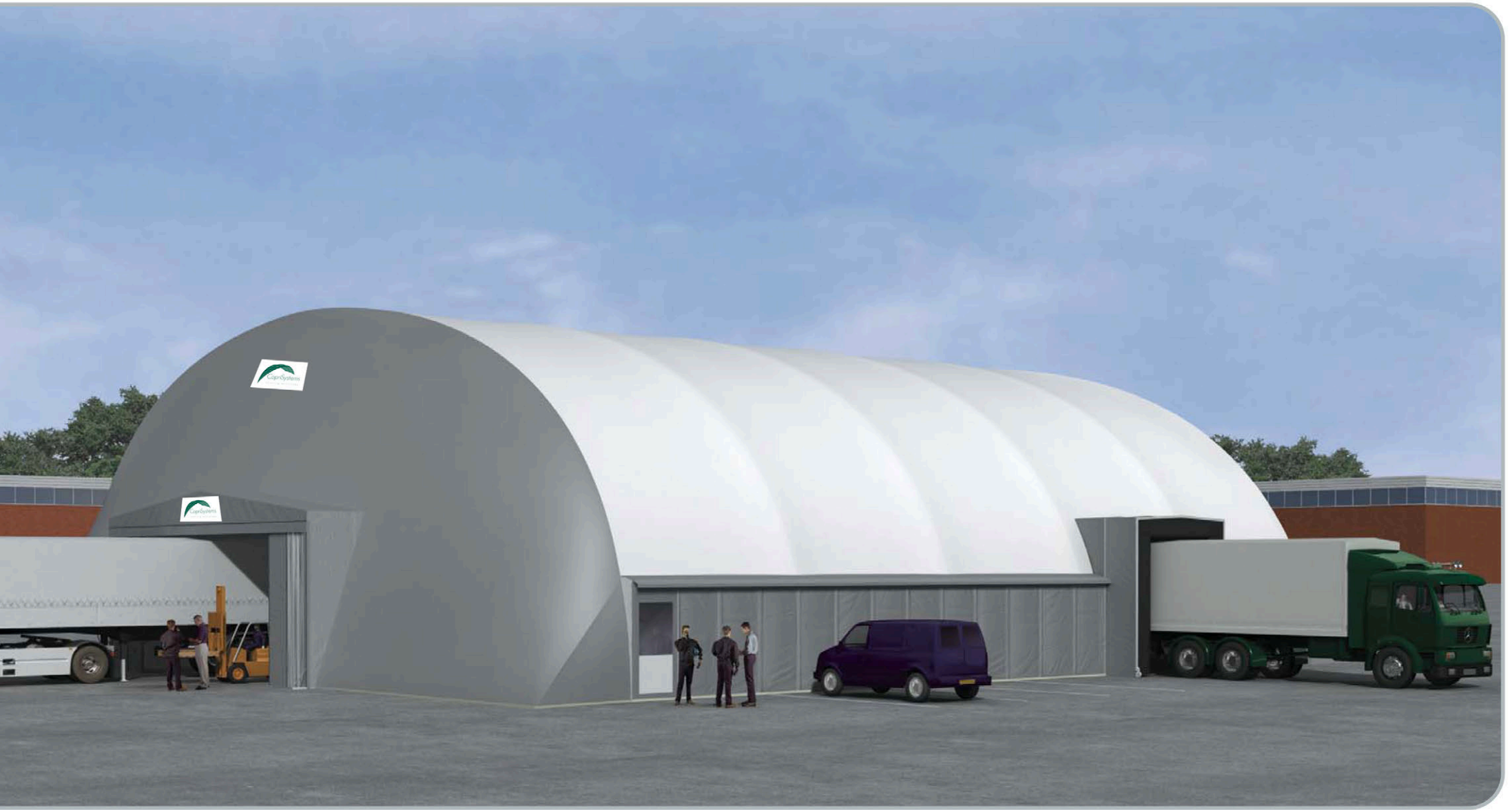

DOCK SHELTERS - GENERAL

CopriSystems' range of specialist dock shelters is manufactured to the highest specification using quality durable materials.

Each model is designed to fulfil specific needs, whether for loading sensitive goods or where space is at a premium. All are flexible to take account of a moving vehicle's ability to cause damage.



Model TR Raised Dock Tunnel Cover



MODEL CT

Raised Cushion Dock Shelter

Fixed or adjustable versions available. Model CT cushion dock shelter is designed for use on raised docks where the vehicle must be precisely positioned, making it particularly suitable where there is a row of docks situated close together. Vehicles are reversed directly and firmly up to the cushion.

- Polyurethane foam padding of width and thickness 300mm.
- 900g/m² cover and protection panels.

Adjustable version

Adjustable version allows top cushion to be raised or lowered to suit different vehicle heights. Counterbalanced for ease of use.



MODEL SR

Raised Recoiling Dock Shelter

Model SR raised recoiling dock shelter provides wrap-around protection for raised docks or ground level forklift access. Side and top panels are held tight against vehicles, protecting against wind. The entire front frame recoils in the event of a vehicle striking it.

- Width and height 3.5m; length 0.6m.
- Heavy duty polyester reinforced rubber top and side panels.
- Parallel swing arms allow front frame to recoil.
- 750g/m² side and top cover.



MODEL TR
Raised Dock Tunnel Cover

Model TR dock tunnel - an extended version of the Model SR - provides weather protection and minimises heat loss over raised exterior loading platforms. Ideal where there is a raised dock with space between vehicle and building. Model TR is also suitable for small vehicle operations or forklift access at ground level.

- Width and height 3.5m; length as required.
- Shock-proof steel pantograph bars.
- Heavy duty polyester reinforced rubber top and side panels or front curtains.
- 750g/m² side and top cover.
- Runs on wheels - in 'L' track if required.



MODEL ST
Full Height Recoiling Dock Shelter

Model ST recoiling dock shelter is for ground floor access situations. Extra lengths incorporating pantographs can reduce the likelihood of a vehicle hitting the door, while the entire front frame recoils in the event of such an event.

- Width 4.25m, height 4.6m or 5.2m; length 1m or as required.
- Heavy duty polyester reinforced rubber top and side panels.
- Parallel swing arms allow front frame to recoil.
- Lower panel available to close beneath vehicle (as shown).
- Runs on wheels - in 'L' track if required.
- 750g/m² side and top cover.



MODEL TC
Foldaway Angled Dock Shelter

Model TC foldaway angled dock shelter is designed for use where space is at a premium; it can be handed either way. Designed for ground floor access situations, the shelter opens between 15° and 90° to accommodate different vehicle positions and provide weather protection.

- Width and height 3.5m or 4.7m
- Shock-proof steel pantograph bars.
- Heavy duty polyester reinforced rubber top and side panels or sliding curtains.
- 750g/m² side and top cover.



MODEL SG
Raised Inflatable Dock Shelter

Model SG inflatable dock shelter provides the ultimate environmental protection. Once the vehicle is in place, the panels inflate around the vehicle, forming a perfect seal.

Model SG is ideally suited to the food industry or where the protection of sensitive goods is paramount. It is used in raised dock situations.

- Width and height 3.5m.
- 3-phase electric motor produces pressure.
- Inflatable tubes made of durable rubber-coated polyester fabric.

TECHNICAL SPECIFICATIONS - CANOPIES AND DOMES

STEEL FRAME AND MODULAR DESIGN

Hot-dip galvanised steel frames provide a strong, corrosion-free structure conforming with BS 6399 Building Regulations (snow and wind loadings) - and engineered to last.

The design of both canopy and warehouse cover is such that length is unlimited, restricted only by the customer's requirements and availability of space.

There is always a fixed frame at the front and rear of each structure, unless rearwall-mounted.

Between the frames, an unlimited number of roof trusses or steel frames can be fitted to increase the length of the building.

CANOPIES

Canopies have steel posts linked by pantographs which operate, using a scissor action, enabling the canopy to fold or extend. If retraction is not required, canopies can be tensioned in the extended position.

The posts have corrosion-proof ball bearing wheels fitted and run on rails bolted to the ground. Brackets prevent uplift. This system allows manual opening and closing of all spans.

The roof can be monopitch or double-pitched using standard-sized roof trusses.

Steel frames are fixed at the front and rear to strengthen the canopy and secure the curtain-style doors. In rearwall-mounted applications, the end frame can be omitted if the canopy is attached to an existing structure.

Standard canopy spans are 4.5m, 6.5m, and from 9m to 24m in 3m steps. Standard 4.3m or 5m heights are sufficient to cover most European lorries. Alternative spans and heights can be produced. Any length can be specified.

WAREHOUSE DOMES

Warehouse domes are constructed using pre-formed sections which are bolted together.

Telescopic models are divided into four sections: the outer two sections are fixed

and do not move; the central two sections are slightly larger, enabling them to slide back over the outer sections when opening. An effective weather seal is formed between the sections.

Standard warehouse dome spans extend from 18m to 36m. The internal height rises quickly at the sides to a central height of 9m for smaller spans, 10m for the greater spans. Any length can be specified.

COVER

All buildings are covered with a heavy duty, flame-retardant PVC-coated polyester fabric which provides protection against the elements, is abrasion resistant and tested to British Standard BS 5438 (flame retardancy). Buildings can also be clad with rigid PVC or steel panels if required.

FOUNDATIONS

CopriSystems' canopies require minimal foundations.

The structures can usually be secured to an existing concrete base. Alternatively,

concrete strip beams can be constructed and the rails incorporated. Beam dimensions depend on building size, topographical and wind conditions. CopriSystems will supply a specification of the ground beam if required.

A concrete ring beam may be required for the larger domes. Alternatively, CopriSystems can supply purpose-made concrete blocks for surface anchoring to indifferent surfaces.

WIND AND SNOW LOADINGS

All buildings are wind and snow load tested to British Standard BS 6399.

RAPID CONSTRUCTION

Canopies can be installed, fully functional and **operational usually within eight weeks** from order. Once manufactured and delivered on site, a small or medium sized canopy can be **erected in a matter of days** on an existing concrete base.

Domes can be erected within two weeks to a prepared concrete base.

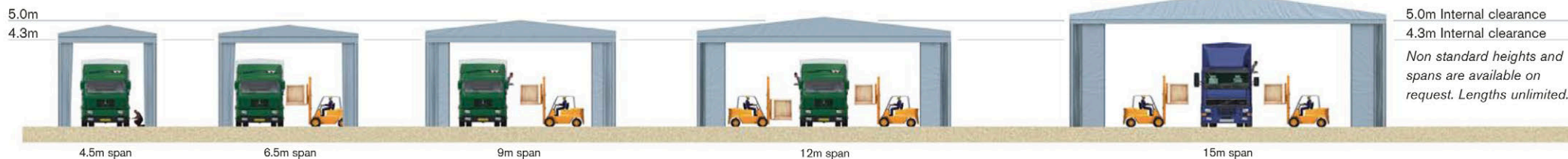

PLANNING PERMISSION

CopriSystems can supply a copy of professional advice regarding planning requirements. Customers should satisfy themselves of the requirements of their particular circumstances.

CopriSystems can make planning applications on behalf of customers.

COLOURS

The cover is supplied in standard colours of goosewing grey, cream, green, black, or white.

Combinations of colours are possible, with a lighter roof giving greater translucency to natural light.

Other colours can be specified.

GROUND LEVELS

Although a flat level plane is the ideal surface for the canopy, provisions can be made for installation on sloping ground – providing the fall is not too great. The canopy may not be able to retract if the slope prohibits it.

DRAINAGE

The design of the cover is such that it will direct water off and away from the canopy. However, if it is felt additional drainage is required, this can be discussed with the customer and provision made.

SEALS & GUTTERS

Canopies can be designed to attach to or stand against an existing building.

Steel posts are bolted to the existing building wall to secure the canopy. The cover is then flashed to the existing building forming an effective seal between the cover and the existing building.

Gutter requirements are reviewed on all sidewall-mounted installations and guttering installed to suit each building type.

MECHANICAL AND ELECTRICAL OPERATIONS

3-phase electric operation can be specified. This is standard for telescopic warehouse covers.

Electric opening of front and rear curtain style doors is also possible.

The design of both the canopy and warehouse is such that opening the curtain doors and folding the canopy back to a fully retracted position is easily achieved by two people.

DOORS AND WINDOWS

Any number and type of doors and windows can be fitted to the building as required. The building design will be tailored accordingly. Options include standard fire and personnel doors, roller shutter doors, swing doors and fast action doors. Dock Shelters can also be added.

DIVIDING CURTAINS

Dividing curtains can be incorporated into the design.

SERVICE

UK-wide service teams provide fast and efficient support, dealing with maintenance or repair issues when required.

Service contracts can be tailored to individual customer needs.

CopriSystems aims to provide a first rate customer service at all times. The customer's needs, the upkeep of the product and the reputation of the Company are paramount.

GUARANTEE

(Subject to conditions)

The CopriSystems steel frames are guaranteed for ten years.

The fabric cover is guaranteed for five years.

SALES & RENTALS

As an alternative to purchase, CopriSystems' Covering Systems can be rented (depending on size) from 3 months up to 5 years, with Lease/Purchase as an option.



18m span



21m span



24m span



Strength and Practicality

